

Microsprinkler and Fogger Parts Assembly

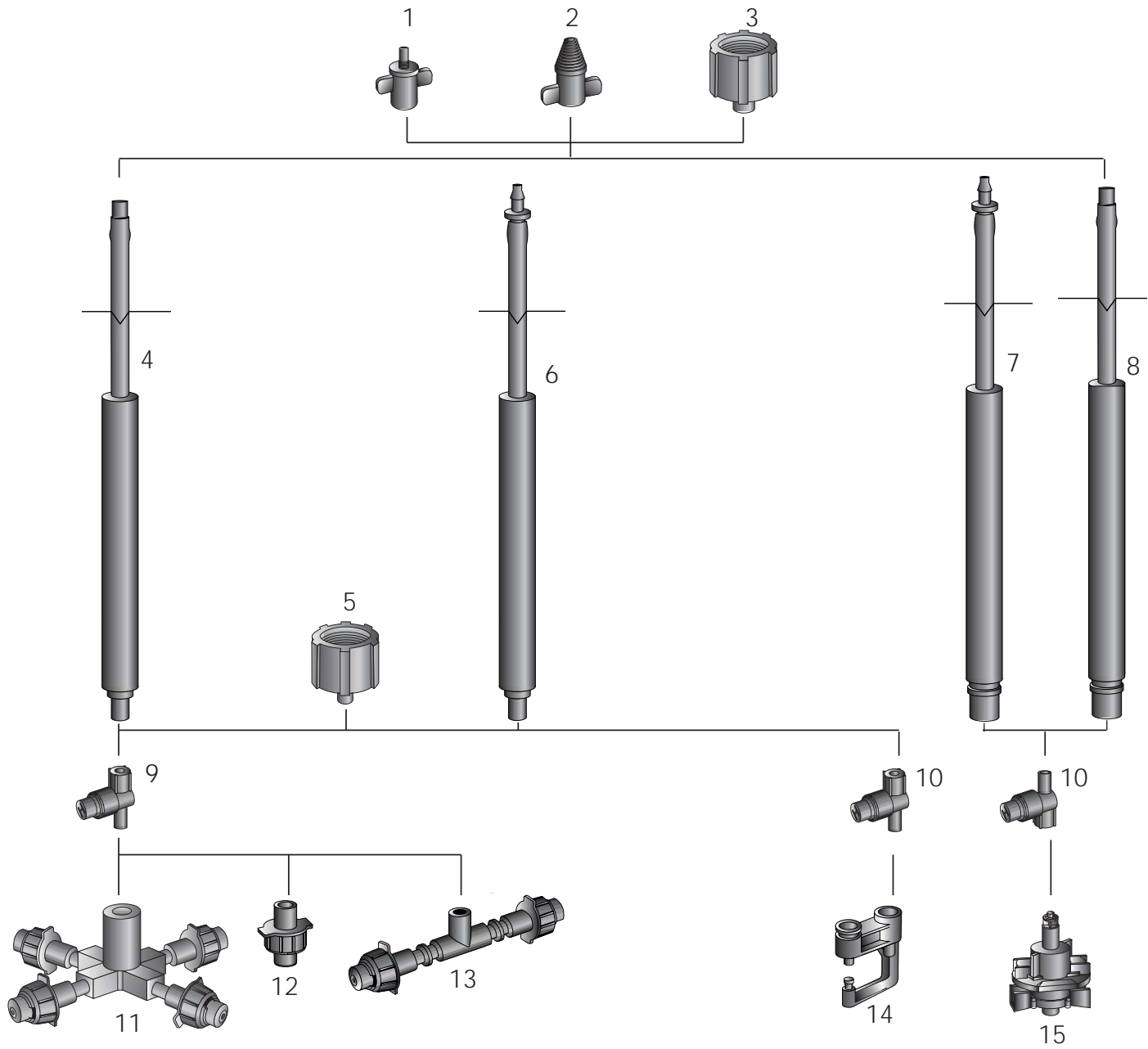

1. Select microsprinkler, microsprayer or fogger

2. Select antileak device

3. Select microtube assembly

PARTS LIST

MODEL	ID #	THREADED BASES
53-132-0	1	10/32 threaded base 700
52-129-0	2	3/8" tapered thread 700
52-882-0	3	1/2" NPT threaded base 700
52-181-0	5	1/2" NPT threaded base 800
MODEL	ID #	VINYL MICROTUBE ASSY W/ WEIGHT .160 ID X .270 OD
50-253-24	4	24" assembly 800 collar x collar
50-253-36	4	36" assembly 800 collar x collar
50-253-48	4	48" assembly 800 collar x collar
50-253-60	4	60" assembly 800 collar x collar
50-254-24	6	24" assembly 800 collar x barb

50-254-36	6	36" assembly 800 collar x barb
50-254-48	6	48" assembly 800 collar x barb
50-254-60	6	60" assembly 800 collar x barb
50-255-24	7	24" assembly 700 plunger x barb
50-255-36	7	36" assembly 700 plunger x barb
50-255-48	7	48" assembly 700 plunger x barb
50-255-60	7	60" assembly 700 plunger x barb
50-256-24	8	24" assembly 800 plunger x 700 collar
50-256-36	8	36" assembly 800 plunger x 700 collar
50-256-48	8	48" assembly 800 plunger x 700 collar
50-256-60	8	60" assembly 800 plunger x 700 collar

MODEL	ID #	ANTILEAK DEVICE
52-530-x	9	Low flow for fogger assembly only
52-530-05	10	Low pressure 700 x 800
52-530-10	10	High pressure 700 x 800
MODEL	ID #	FOGGERS AND MICROSPRINKLERS
50-501-xx	12	Fogger, single head
50-502-xx	13	Fogger, double heads
50-504-xx	11	Fogger, quadruple head
52-038-xx	14	Microsprayer
52-866-xx	15	Microsprinkler

EXL-Fogger Series 500

Model 50-50x-xx

EXL 500 is designed as a low flow fogger head with micro-sized droplets. Design flexibility is achieved with interchangeable components, maximizing your cooling and humidifying options. DIG'S EXL 50-500-xx fogger can significantly reduce the temperature inside greenhouses and maintain ideal humidity for propagation.

- Designed without a bridge to prevent dripping
- Three part construction with "O" ring for a tight seal
- Manufactured from superior durable plastics for extended life operation
- Available on 1/2", 3/8" or 10/32" threaded base or completely assembled with 24" (60 cm), 36" (90 cm), 48" (122 cm), 60" (152 cm), 160 ID x .270 OD (4/7) microtube, weight and antileak device

Applications:

- Mist cooling and humidifying
- Root Development

Features:

- Incorporates a vortex mechanism, breaking the water into micro-sized droplets
- Can be used for overhead cooling and humidifying in a closed structure
- Interchangeable color coded nozzles
- Can be used on an antileak device with one, two, three or four misting head assemblies

Performance and Technical Data:

- Material male and female body: polybutylene (PB), "O" ring: Buna N, nozzle: acetal
- ° Nominal flow rate at 50 PSI (3.5 bar)
- Pattern: 360°
- Trajectory angle: approximately 30-35°
- Average droplet size is 50 to 100 microns
- Filter requirements: flow up to 1.5 GPH (6 l/h) minimum of 200 mesh (80 microns), 2 GPH (8 l/h) and up to 155 mesh (100 micron)
- Used only with Antileak Model 52-830-X

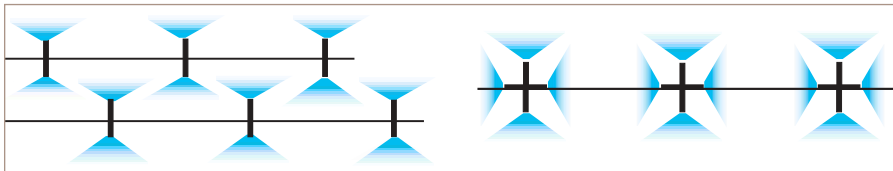

FLOW RATE AND DIAMETER														
Model Number	Nozzle Color	Nozzle Size	Nominal Flow Rate	30 PSI	35 PSI	40 PSI	45 PSI	50 PSI	55 PSI	60 PSI	65 PSI	70 PSI	Diameter (feet)	Misting angle
50-501-13	Black	0.013"	1	0.85	0.91	0.98	1.04	1.07	1.14	1.17	1.20	1.26	3.0'	70
50-501-20	Green	0.020"	1.5	1.26	1.36	1.49	1.52	1.58	1.64	1.71	1.74	1.82	3.5'	70
50-501-25	Brown	0.025"	2	1.58	1.68	1.83	1.91	2.02	2.09	2.18	2.26	2.31	3.5'	70
50-501-35	Gray	0.035"	3	2.21	2.40	2.61	2.78	2.91	3.02	3.17	3.26	3.42	4.0'	80

PERFORMANCE AT 6' (1.8M) HEIGHT					
PERFORMANCE at 50 PSI (3.5 bar), single head					
Nozzle Colors	Black		Green	Brown	Gray
Flow rates (GPH)	1.07		1.58	2.02	2.91
Wetting diameter (feet)	3.2		3.5	3.5	4.0
Rectangular spacing (ft x ft)	3 x 3		3 x 4	3 x 4	3 x 4
Application rate (in/h)	0.10		0.12	0.13	0.18
PERFORMANCE at 50 PSI (3.5 bar), two way head assembly					
Flow rates (GPH)	2.34		3.42	4.36	6.34
Wetting diameter (feet)	3.2		3.5	3.5	4.0
Triangular spacing (ft x ft)	4 x 4		4 x 4	4 x 4	4 x 4
Application rate (in/h)	0.23		0.24	0.43	0.63
PERFORMANCE at 50 PSI (3.5 bar), four way head assembly					
Flow rates (GPH)	4.68		6.84	8.72	12.68
Rectangular spacing (ft x ft)	4 x 4		4 x 4	4 x 4	4 x 4
Application rate (in/h)	0.47		0.68	.087	1.27



ORDERING INFORMATION	
Model	Description
50-501-xx	Single fogger assembly
50-502-xx	2-way fogger assembly
50-504-xx	4-way fogger assembly
52-530-x	Anti-leak device (low pressure)
50-254-xx	Microtube assembly with weight
52-181-0	1/2" base

Microsprayer Series 038

Model 52-038-xx

Designed for use in greenhouses, 52-038-xx microsprayers have very fine droplets and are available in a wide range of flow rates for maintaining ideal growth conditions in propagation and germination. An optional antileak device prevents dripping at the beginning and the end of each irrigation cycle, keeping the entire line pressurized.

Applications:

- Use in germination, seeding and rooting in greenhouses and nurseries
- Use for overhead irrigation, propagation and cooling in greenhouses and nurseries

Features:

- Excellent performance with uniform water distribution
- Color coded nozzles for flow rate identification
- Modular design allows for a wide range of interchangeable components
- Suitable for upright and inverted position

Benefits:

- Maintains constant humidity or cooling in greenhouses
- High uniformity due to distribution accuracy and low precipitation rate

Performance and Technical Data:

- Material: polyacetal
- Flow rates from 9 to 42 GPH (35 l/h to 160 l/h)
° Nominal flow rate at 29.4 PSI
- Wetting diameter: 6.5' to 13' (1.9 to 3.9 m)
- Operating pressure: 20 to 35 PSI (1 to 2.4 bar)
- Operating pressure for overlap irrigation: 35 PSI (2.4 bar)
- Pattern: 340°
- Trajectory angle: approximately 1°
- Average droplet size: .0008" (0.2 mm) very fine at 45 PSI
- Filter requirements: 120 mesh (130 micron) up to 24 GPH, 24 to 42 GPH 80 mesh (180 micron)



FLOW RATE AND DIAMETER							
Model	52-038-09	52-038-13	52-038-15	52-038-18	52-038-24	52-038-32	52-038-42
Nozzle colors	Lt. blue	Violet	Gray	Black	Green	Red	Brown
Nozzle size	.031"	.039"	.043"	.047"	.051"	.059"	0.71"
NOMINAL FLOW RATE at 29.4 PSI (2 bar)							
Flow rates (GPH)	9	13	15	18	24	32	42
Wetting diameter (feet)	8	8	9	9	10	11	12
PERFORMANCE AND TECHNICAL DATA INVERTED AT 6' (1.80M) HEIGHT							
PERFORMANCE at 20 PSI (1.4 bar)							
Flow rates (GPH)	7.8	11.1	13.3	15.5	20.0	26.6	35.5
Wetting diameter (feet)	6.5	7	8	8.5	9	10	11
PERFORMANCE at 25 PSI (1.7 bar)							
Flow rates (GPH)	9.6	12.4	14.9	17.4	22.3	29.7	39.7
Wetting diameter (feet)	7.3	8	9	9.2	9.7	10.5	11.7
PERFORMANCE at 30 PSI (2.1 bar)							
Flow rates (GPH)	9.5	13.6	16.3	19.0	24.4	32.6	43.4
Wetting diameter (feet)	8	9	9.8	10	10	11	12
PERFORMANCE at 35 PSI (2.4 bar)							
Flow rates (GPH)	10.3	14.7	17.6	20.5	26.4	35.2	46.9
Wetting diameter (feet)	8.4	9.2	10	10.4	10.7	11.5	13
Rectangular spacing (ft x ft)	3 x 4	3 x 4	3 x 4	3 x 4	4 x 5	4 x 5	4 x 5
Application rate (in/h)	1.4	2.0	2.3	2.7	2.1	2.3	3.1



ORDERING INFORMATION	
Model	Description
52-038-xx	Microsprayer
52-530-05	Anti-leak device (low pressure)
52-530-10	Anti-leak device (high pressure)
50-254-xx	Microtube assembly with weight
52-181-0	1/2" base

Mini-compact Microsprinkler Series 866

Models 52-866-xx

Mini-compact model 52-866-xx is a highly efficient microsprinkler designed to irrigate in an inverted position in greenhouses. It can be connected directly to a lateral with or without an antileak device to prevent dripping at the beginning or at the end of each irrigation cycle, keeping the entire line pressurized.

Applications:

- Suits all applications in irrigation and propagation
- Use in greenhouses and nurseries

Features:

- Excellent performance with uniform water distribution
- Trouble free operation even at low pressure
- Color coded specially designed nozzle with backup filter
- Firm compact construction without a bridge gives a complete 360° circle
- Modular design allows for wide range of interchangeable components
- Nozzle has a small backup filter for protection against penetration of dirt

- Made of durable plastic materials ensuring resistance to most chemicals and fertilizers for long-lived trouble free operation

Benefits:

- Allows a large number of microsprinklers to operate at the same time due to lower flow rate
- Uniform growth of root system due to optimal ratio of water in the soil

Performance and Technical Data:

- Material: polyacetal
- Flow rates: 9 to 42 GPH (35 to 160 l/h)
- Diameter coverage: 15' to 29' (4.5 to 8.7 m)
- Operating pressure: 15 to 35 PSI (1 to 2.4 bar)
- Operating pressure in overlapping: 25 to 30 PSI (1.7 to 2.0 bar)
- Pattern: 360°
- Trajectory angle: approximately -5°
- Droplet size: medium
- Filter requirement: 120 mesh (130 micron) up to 24 GPH, 24 to 42 GPH 80 mesh (180 micron)



FLOW RATE AND DIAMETER								
Model	52-866-09	52-866-10	52-866-13	52-866-15	52-866-18	52-866-24	52-866-32	52-866-42
Nozzle Color	Lt. Blue	Silver Blue	Violet	Gray	Black	Green	Red	Brown
Nozzle size (inch)	.031	.035	.039	.043	.04	.051	.059	.071
NOMINAL FLOW RATE at 29.4 PSI (2 bar)								
Flow rates (GPH)	9	10	13	15	18	24	32	42
Wetting diameter (feet)	18	20	22	23	25	28	29	33
PERFORMANCE AT 6' (1.8M) HEIGHT								
PERFORMANCE at 20 PSI (1.4 bar)								
Flow rates (GPH)	7.8	8.9	11.0	13.1	15.5	20.0	26.6	35.5
Wetting diameter (feet)	15	17	18	20	21	22	23	25
PERFORMANCE at 25 PSI (1.7 bar)								
Flow rates (GPH)	8.6	9.9	12.4	14.9	17.4	22.3	29.7	39.7
Wetting diameter (feet)	17	18	19	21	23	23	24	26
Rectangular Spacing (feet)	8 x 10	8 x 10	10 x 10	12 x 12	12 x 12	12 x 12	12 x 16	12 x 16
Application rate (in/hr)	0.17	0.19	0.19	0.17	0.19	0.24	0.24	0.33
PERFORMANCE at 30 PSI (2.1 bar)								
Flow rates (GPH)	9.5	10.9	13.6	16.3	19.0	24.4	32.6	43.4
Wetting diameter (feet)	18	19	21	22	24	25	26	28
Rectangular Spacing (feet)	10 x 12	12 x 12	12 x 12	13 x 15	15 x 15	15 x 15	16 x 16	16 x 18
Application rate (in/hr)	0.19	0.21	0.21	0.18	0.21	0.27	0.17	0.36
PERFORMANCE at 35 PSI (2.4 bar)								
Flow rates (GPH)	10.3	11.7	14.7	17.6	20.5	26.4	35.2	46.9
Wetting diameter (feet)	18	20	22	23	24	26	28	29
Rectangular Spacing (feet)	10 x 12	12 x 12	12 x 12	13 x 15	15 x 15	15 x 15	16 x 16	16 x 18
Application rate (in/hr)	0.20	0.23	0.23	0.20	0.22	0.29	0.29	0.39



ORDERING INFORMATION	
Model	Description
52-866-xx	Microsprinkler
52-530-05	Anti-leak device (low pressure)
52-530-10	Anti-leak device (high pressure)
50-254-xx	Microtube assembly with weight
50-822-0	1/2" base

Minisprinkler Series 700

Model 52-700-xx

Series 52-700-xx minisprinkler is an insect proof dynamic sprayer for under canopy irrigation with a full range of flow rates and excellent distribution uniformity.

Applications:

- Suits all applications in the irrigation of seedlings, young saplings and mature trees
- Use in orchards, greenhouses and nurseries

Features:

- Excellent performance with uniform water distribution
- Press fit configuration for easy maintenance
- Head closes downwards after operation to prevent dirt and insects from entering the sprinkler (insect proof)
- Dynamic operation ensures self-cleaning and prevents accumulation of deposits, making it suitable for irrigation water containing iron and calcium
- Firm construction, without a bridge, gives a complete 360° circle
- Available on 1/2", 10/32" FNPT or completely assembled on 13" spike with 24" or 36" .160 ID x .270 OD microtube
- Can operate upside down to reduce wetting diameter for young trees

Benefits:

- Low precipitation rate for any soil structure
- Can be used for frost protection and cooling

Performance and Technical Data:

- Material: polyacetal
- Flow rates from 11 to 42 GPH (40 l/h to 160 l/h)
- Diameters between 6' to 17' (1.8 to 5.1 m)
- Operating pressure: 25 to 35 PSI (1.7 to 2.4 bar)
- Operating pressure in overlapping irrigation: 35 PSI (2.4 bar)
- Pattern: full circle 360°
- Trajectory angle: approximately 30°
- Droplet size: medium
- Filter requirement: up to 24 GPH 120 mesh (130 micron) 24 GPH and up 80 mesh (180 micron)



FLOW RATE AND DIAMETER							
Model	52-700-10	52-700-15	52-700-18	52-700-24	52-700-27	52-700-32	52-700-42
Nozzle colors	Lt. blue	Gray	Black	Green	N. blue	Red	Brown
Nozzle size	.035"	.043"	.047"	.051"	.055"	.059"	.071"
NOMINAL FLOW RATE at 29.4 PSI (2 bar)							
Flow rates (GPH)	10	15	18	24	27	32	42
Wetting diameter (feet)	10	11	13	14	15	16	17
PERFORMANCE AT 12" (30CM) ABOVE THE GROUND							
PERFORMANCE at 25 PSI (1.7 bar)							
Flow rates (GPH)	9.9	14.9	17.4	22.3	26.0	29.7	39.7
Wetting diameter (feet)	6	10	11	12	13	14	15
PERFORMANCE at 30 PSI (2.1 bar)							
Flow rates (GPH)	10.9	16.3	19.0	24.4	28.5	32.6	43.4
Wetting diameter (feet)	7	11	12	14	16	15	16
PERFORMANCE at 35 PSI (2.4 bar)							
Flow rates (GPH)	11.7	17.6	20.5	26.4	30.8	35.2	46.9
Wetting diameter (feet)	10	11	13	14	15	16	17
Rectangular spacing (ft x ft)	6 x 4	7 x 6	7 x 6	8 x 6	8 x 6	10 x 6	10 x 6
Application rate (in/h)	0.78	0.62	0.78	0.88	1.02	0.94	1.25

ORDERING INFORMATION	
Model	Description
52-700-xx	Minisprinkler only
50-430-0	13" Press fit stake
50-156-24	24" Microtube assembly
50-156-36	36" Microtube assembly
52-822-0	1/2" base

Mini-compact Microsprinkler Series 861

Models 52-861-xx & 52-863-05

Mini-compact microsprinklers present an advanced concept in micro irrigation. Their uniquely designed drive mechanism achieves a strong spinner propulsion at low pressure. A small backup filter ensures extra protection, and also serves as a secondary nozzle to slow velocity, keeping the droplet size even and providing excellent distribution uniformity. Mini-compact microsprinklers use interchangeable components and a large selection of nozzles, suitable for all applications in the irrigation of seedlings, young saplings and mature trees.

Applications:

- Use in orchards, greenhouses and nurseries
- Can be used for frost protection and cooling

Features:

- Excellent performance with uniform water distribution
- Large water passage
- Head closes downwards after operation to prevent dirt and insects from entering the sprinkler (insect proof)
- Built-in filter

- Trouble free operation even at low pressure
- Strong spinner propulsion at low pressure
- Frame construction without a bridge allows a complete 360° circle
- Available on 1/2" FNPT, 10/32 thread or completely assembled on 13" spike with 24", 36" or 48" .160 ID x .270 OD microtube
- Made of durable plastic materials, ensuring resistance to most chemicals and fertilizers
- The microsprinkler has a small backup filter for protection

Benefits:

- Low water tension in the soil prevents plant stress
- Optimum soil aeration due to low precipitation rate
- No run off or soil erosion



Performance and Technical Data:

- Material: polyacetal
- Flow rates from 5 GPH to 42 GPH (20 l/h to 160 l/h)
- Diameter of coverage: between 10' to 28' (3.0 m to 8.5 m)
- Operating pressure: 15 to 30 PSI (1 to 2.0 BAR)
- Pattern: 360°
- Trajectory angle: approximately 12°
- Droplet size: medium
- Filter requirement: minimum of 120 mesh (130 micron)



FLOW RATE AND DIAMETER									
Model	52-863-05	52-861-09	52-861-10	52-861-13	52-861-15	52-861-18	52-861-24	52-861-32	52-861-42
Nozzle Color	Olive	Lt. Blue	Silver Blue	Violet	Gray	Black	Green	Red	Brown
Nozzle size	.035"	.031"	.035"	.039"	.043"	.047"	.051"	.059"	.071"
NOMINAL FLOW RATE at 29.4 PSI (2 bar)									
Flow rates (GPH)	5	9	10	13	15	18	24	32	42
Wetting diameter (feet)	10	15	18	20	22	23	24	26	28
PERFORMANCE AND TECHNICAL DATA at 6' (1.8m) above the ground									
PERFORMANCE at 15 PSI (1 bar)									
Flow rates (GPH)	n/a	6.7	7.7	9.6	11.5	13.4	17.3	23.0	30.7
Wetting diameter (feet)	n/a	10	12	14	16	17	18	21	23
PERFORMANCE at 20 PSI (1.4 bar)									
Flow rates (GPH)	n/a	7.8	8.9	11.1	13.3	15.5	20.0	31.0	35.5
Wetting diameter (feet)	n/a	12	14	16	18	20	21	23	25
PERFORMANCE at 25 PSI (1.7 bar)									
Flow rates (GPH)	4.9	8.7	9.9	12.4	14.9	17.4	22.3	29.7	39.7
Wetting diameter (feet)	8	13	15	17	19	21	21	25	27
PERFORMANCE at 30 PSI (2.1 bar)									
Flow rates (GPH)	5.4	9.5	10.9	13.6	16.3	19.0	24.4	32.6	43.4
Wetting diameter (feet)	10	15	18	20	22	23	24	26	28
Rectangular spacing	5 x 7	12 x 10	14 x 12	14 x 12	14 x 12	14 x 12	16 x 14	16 x 14	16 x 14
Application rate (in/hr)	0.24	0.12	0.10	0.13	0.15	0.18	0.17	0.23	0.31

ORDERING INFORMATION	
Model	Description
52-861-xx	Minisprinkler only
50-430-0	13" Press fit stake
50-156-24	24" Microtube assembly
50-156-36	36" Microtube assembly
52-882-0	1/2" base

Flow Regulated Mini-compact Microsprinkler

Models 55-861-xx

Mini-compact microsprinklers are designed to achieve a consistent flow rate in areas with pressure fluctuations or difficult topography.

Applications:

- Systems with constantly changing pressures
- Slopes and locations with difficult topography

Features:

- Cost reductions due to smaller diameter pipe and longer laterals
- Stake has depth measurements imprinted for precise installation
- Integral filter to protect the regulating silicon disc from a large particles
- Head closes downwards after operation to prevent dirt and insects from entering the sprinkler (insect proof)
- Press fit configuration for easy maintenance
- No misting

- Trouble free operation, even at low pressure
- Strong propulsion of the spinner at low pressure
- Frame construction without a bridge gives a complete 360° circle
- Standard assembly includes 24" .160 OD x .270 ID microtube, spike and barb
- Made of durable plastic materials ensuring resistance to most chemicals and fertilizers used in agriculture

Performance and Technical Data:

- Material: polyacetal
- Pattern: 360°
- Flow rate: 7, 11 and 15 GPH (1.4 to 3.1 bar)
- Diameter of coverage 16' to 18' (4.8m to 5.4m)
- Operating pressure: 20 to 50 PSI
- Trajectory angle: approximately 11°
- Droplet size: medium
- Filter requirement: minimum of 120 mesh (130 micron)
- Nozzle has a small backup filter for protection against penetration of dirt

FLOW RATE AND DIAMETER						
Model	Nozzle Size	Nozzle Color	Flow (GPH)	Flow (l/h)	Diam. (ft)	Diam. (m)
55-861-07	.039"	Violet	7	25	16	4.8
55-861-11	.047"	Black	10.5	40	17	5.0
55-861-15	.047"	Black	15	55	18	5.4

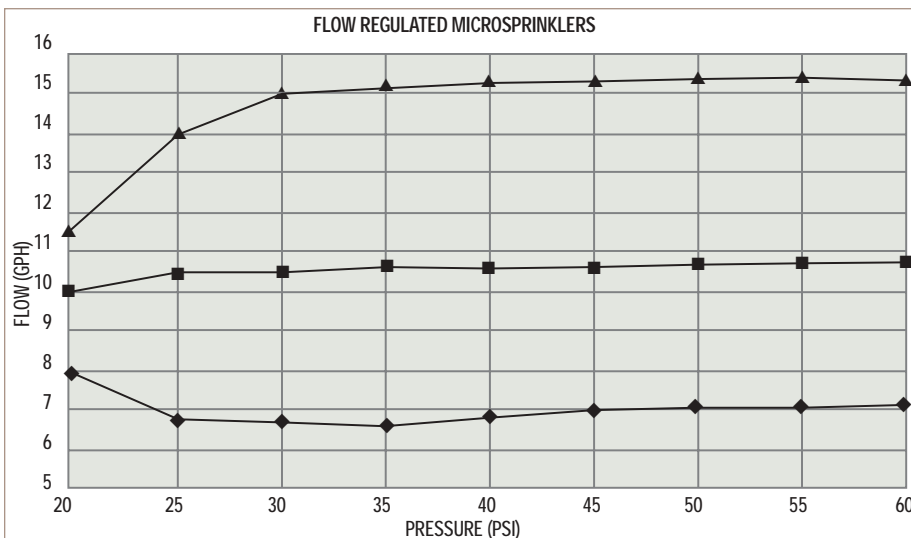

ORDERING INFORMATION

Model	Description
55-861-07	Microsprinkler assembly, 7 GPH
55-861-11	Microsprinkler assembly, 11 GPH
55-861-15	Microsprinkler assembly, 15 GPH

Microsprinkler Series 084

Models 52-084-xx

Series 084 microsprinklers are designed to operate with poor water quality conditions and are insect resistant. The water velocity moving through the small size insect-proof spinner produces strong propulsion allowing a large coverage of up to 30 feet. When the water is turned off, the spinner drops back and seals the nozzle against incursion of insects.

Applications:

- Suits all applications in the irrigation of young saplings and mature trees
- Use in orchards, greenhouses and nurseries

Features:

- Press-fit configuration for easy maintenance
- Anti-insect, retractable spinner closes when irrigation cycle is complete
- High uniformity due to advanced spinner design
- Available completely assembled on 13" spike with 24" or 36" .160 ID x .270 OD microtube

- Optimum soil aeration due to a low precipitation rate and uniform water distribution
- Detachable color coded nozzles for easy flow identification
- Made of durable plastic materials, ensuring resistance to most chemicals and fertilizers used in irrigation for long trouble free operation

Benefits:

- Low flow rates enable model 940 to operate with a large number of microsprinklers per acre in overlapping irrigation
- Plant stress can be prevented by low water tension in the soil, achieved with low rain-ratio
- Optimum growth due to precise application of water and fertilizer through the irrigation system

Performance and Technical Data:

- Material: polyasetal
- Flow rate: 9-42 GPH (35-160 l/h)
- Diameter of coverage: 16' to 30' (4.8m to 9m)
- Operating pressure: 15-30 PSI (1.0 to 2.4 bar)
- Operating pressure in overlapping irrigation: 30 PSI (2.4 bar)
- Pattern: 360°
- Trajectory Angle: Approximately 10°
- Filter Requirement: Minimum of 120 mesh (30 micron)



FLOW RATE AND DIAMETER						
Model	50-084-09	50-084-15	52-084-18	52-084-24	52-084-32	52-084-42
Nozzle colors	Lt. Blue	Grey	Black	Green	Red	Brown
Nozzle size	.031"	.043"	.047"	.051"	.059"	.059"
NOMINAL FLOW RATE at 29.4 PSI (2 bar)						
Flow rates (GPH)	9.0	15	18	24	32	42
Wetting diameter (feet)	16	21	22	24	27	30
PERFORMANCE AT 12" (30CM) ABOVE THE GROUND						
Performance at 15 PSI (1.0 bar)						
Flow rate (GPH)	6.7	11.5	13.4	17.3	23.0	30.7
Wetting diameter (feet)	11	14	15	17	20	22
Performance at 20 PSI (1.4 bar)						
Flow rate (GPH)	7.8	13.3	15.5	20.0	31.0	35.5
Wetting diameter (feet)	12	16	18	20	22	24
Performance at 25 PSI (1.75 bar)						
Flow rate (GPH)	8.7	14.9	17.4	22.3	29.7	39.7
Wetting diameter (feet)	13	18	20	21	24	26
Performance at 30 PSI (2.1 bar)						
Flow rate (GPH)	9.5	16.3	19.0	24.4	32.6	43.4
Wetting diameter (feet)	16	22	23	24	27	30
Rectangular Spacing	4 x 4	5 x 4	5 x 4	6 x 5	6 x 5	8 x 6
Application rate (in/hr)	0.35	1.30	1.52	1.30	1.74	1.45

ORDERING INFORMATION	
Model	Description
52-084-xx	Microsprinkler only
50-430-0	13" Press fit stake
50-154-24	24" Microtube assembly
50-154-36	36" Microtube assembly
50-181-0	1/2" base

Compact Microsprinkler Series 961

Models 52-961-xx & 52-961P-32

A unique single stream low volume, low trajectory compact microsprinkler with a turbine mechanism, offering smooth operation and uniform water distribution; necessary for overlapping irrigation. The fully adjustable arc offers a wide selection of irrigation coverage. An insect proof nozzle assures trouble free operation.

Applications:

- Use in orchards, greenhouses and nurseries
- Use for frost protection and cooling

Features:

- Excellent performance with uniform water distribution
- Head closes downwards after operation to prevent dirt and insects from entering the sprinkler (insect proof)
- Modular design allows for a wide range of interchangeable components
- Built-in unique backup filter
- 52-961P-32 has an adjustable arc to any sector with easy adjustment
- Simple construction without spring and seals
- Available on 1/2" FNPT, 10/32" thread or completely assembled with 13" spike, or iron rod with 24" or 36" .160 ID x .270 OD microtube

Performance and Technical Data:

- Material: polyacetal
- Diameter of coverage: 40' to 42'
- Flow rate: 32-42 GPH (124 and 162 l/h)
- Operating pressure: 30 to 35 PSI (2 to 2.4 bar)
- Operating pressure in overlapping irrigation: 35 PSI (2.4 bar)
- Maximum spacing for overlapping: up to 20 x 20 ft (6 x 6 m)
- Pattern: part circle 30° to 380°, full circle 360°
- Trajectory angle: approximately 10°
- Single jet
- Droplet size: large
- Filter requirement: minimum of 60 mesh (220 micron)



FLOW RATE AND DIAMETER			
Model	52-961P-32	52-961-32	52-961-42
Nozzle Color	Red	Red	Brown
Nozzle size	.059"	.059"	.071"
NOMINAL FLOW RATE at 29.4 PSI (2 bar)			
Flow rates (GPH)	32	32	42
Wetting diameter (feet)	40	40	42
PERFORMANCE AND TECHNICAL DATA at 12" (30cm) above the ground			
PERFORMANCE at 30 PSI (2 bar)			
Flow rates (GPH)	32.6	32.6	43.3
Wetting diameter (feet)	40	40	42
PERFORMANCE at 35 PSI (2.4 bar)			
Flow rates (GPH)	35.2	35.2	46.9
Wetting diameter (feet)	40	40	42
Rectangular spacing (ft x ft)	18 x 18	18 x 18	20 x 20
Application rate (in/hr)	0.17	0.17	0.18

ORDERING INFORMATION	
Model	Description
52-961-32	Microsprinkler only
52-961-42	Microsprinkler only
52-961-32	Microsprinkler only
50-430-0	13" Press fit stake
50-156-24	24" Microtube assembly
50-156-36	36" Microtube assembly
50-882-0	1/2" base

Antileak Device

Models 52-530-xx

DIG's antileak device is a water pressure valve which opens and closes instantly when pressure builds up. This action prevents the microsprinkler or mister from dripping as a result of the gradual increase or decrease of water pressure when opening and closing the water line. The antileak can be used with all DIG products.

Applications:

- Greenhouse irrigation and misting systems
- Seedling and rooting systems

- Pulse irrigation to avoid air formation in the pipe and the time required for pressure to rise after each pulse
- Slope irrigation to prevent the overflow of water emptying the line when the water is shut off

Features:

- Designed with a stainless steel spring for long lasting uniform operation
- Can be connected to microsprinkler, mister or fogger from either side
- Wide water passage for low maintenance
- Prevents damage to sensitive plants caused by dripping at the beginning and end of each irrigation cycle

- Pulse irrigation system to avoid air formation in the pipe and in each pressure rise in the system
- Prevents overflow drain from the lateral when water is shut off

Performance and Technical Data:

- Material: polyacetal body, silicon diaphragm and stainless steel spring
- Operating pressure: up to 65 PSI (4.5 bar)
- Local head loss against arrow direction: at 18 GPH 0.7 PSI (70 l/h 0.05 bar)
- Local head loss against arrow direction: at 28 GPH 1.4 PSI (105 l/h 0.10 bar)
- Press fit connection from male or female side

PERFORMANCE AND TECHNICAL DATA							
Model	Color	Opening Pressure		Closing Pressure		Opening Pressure	
		(*PSI)	(*bar)	(PSI)	(bar)	(+ PSI)	(+ bar)
Performance							
50-530-10 (H)	Black	16-22	1.1-1.5	10-12	0.75-0.95	16-23	1.1-1.6
52-530-05 (L)	Black	11-17	0.8-1.2	4-6	0.35-0.45	11-18	0.8-1.3
52-530-X**	Black	29-36	2.1-2.6	18-21	1.3-1.5	—	—
*Arrow direction + opposite to arrow direction			**Used with Series 500 fogger only				
The attachment of the antileak device to a microsprinkler or fogger is by press fit design. The arrow mark indicates a male connection, the opposite direction indicates a female connection. Suitable for all microsprinklers, sprayers and foggers.							



ORDERING INFORMATION	
Model	Description
52-530-10	High pressure antileak
52-530-05	Low pressure antileak
52-530-04	Low flow antileak

Irrigation & Propagation AC & DC Controllers

Models 5006-IP 6-Station and 510.xxxP Single Station

Designed for irrigation and propagation in greenhouses and nurseries, Models 5006-IP AC controller and 510.xxxP battery operated controller have features such as watering durations in seconds or minutes and repeat watering cycles at selected times of the day. A flexible program and the simplest of operations make the 5006-IP and 510.xxxP the ideal controllers for recurring program cycles.

Application:

- Irrigation, propagation and germination

Features:

- Independent program for each valve (6-station)
- Can be programmed to serve a wide range of applications and provide flexibility in setting irrigation schedules
- Internal circuit board eliminates the need for fuses or a circuit breaker

Technical Data:

- Duration from 1 second up to 12 hours in 1 second increments
- Repeat watering cycle in 1 minute intervals with window to start at AM or PM, and window to close at AM or PM. Allows watering in short cycles during limited periods of the day or night



ORDERING INFORMATION	
Model	Description
5006-IP	AC six station
510-075P	3/4" DC single station
510-100P	1" DC single station

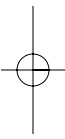
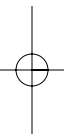
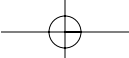

1210 Activity Drive • Vista, California 92081-8510
800-322-9146 • 760-727-0914 • FAX 760-727-0282
www.digcorp.com

© COPYRIGHT 2006. ALL RIGHTS RESERVED. PRINTED IN U.S.A. 2005-2006. 110603 CATALOG 41-010

 WE AT DIG STRONGLY BELIEVE IN RECYCLING. PLEASE RECYCLE

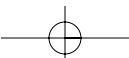



2006 Greenhouse Irrigation Products